

Compressed air consumption: 200 litre/minute  
 System pressure: 6-8 bar  
 Power Supply: 3x215V AC + N + PE 50CPS  
 Fuse: 160A slow  
 Minimal cable dimension: 5x70mm<sup>2</sup> (max. length 90m)

For approval  
 Atlas Ward Structures Ltd.  
 ..... - 2000

WERK:	V550A CNC Punching & Shearing line	A 28-09-'00
ONDERDEEL:	Lay-out	
OPDRACHTGEVER:	Atlas Ward Structures Ltd.	
SCHAAL:	1:50	FORMAAT: 841x420
DETAILS:	DATUM: 04-09-2000	GETEKEND: G. Koster
VOORTMAN AUTOMATISERING POSTBUS 83 7460 AB NIJMEGENSTRAAKT 44 7461 AE RIJSEN tel: 0548-539200 fax: 0548-539200		PROEKNUMMER: 00.2047.00 TEKENNUMMER: 0.00 00204700\Atlas000.dwg

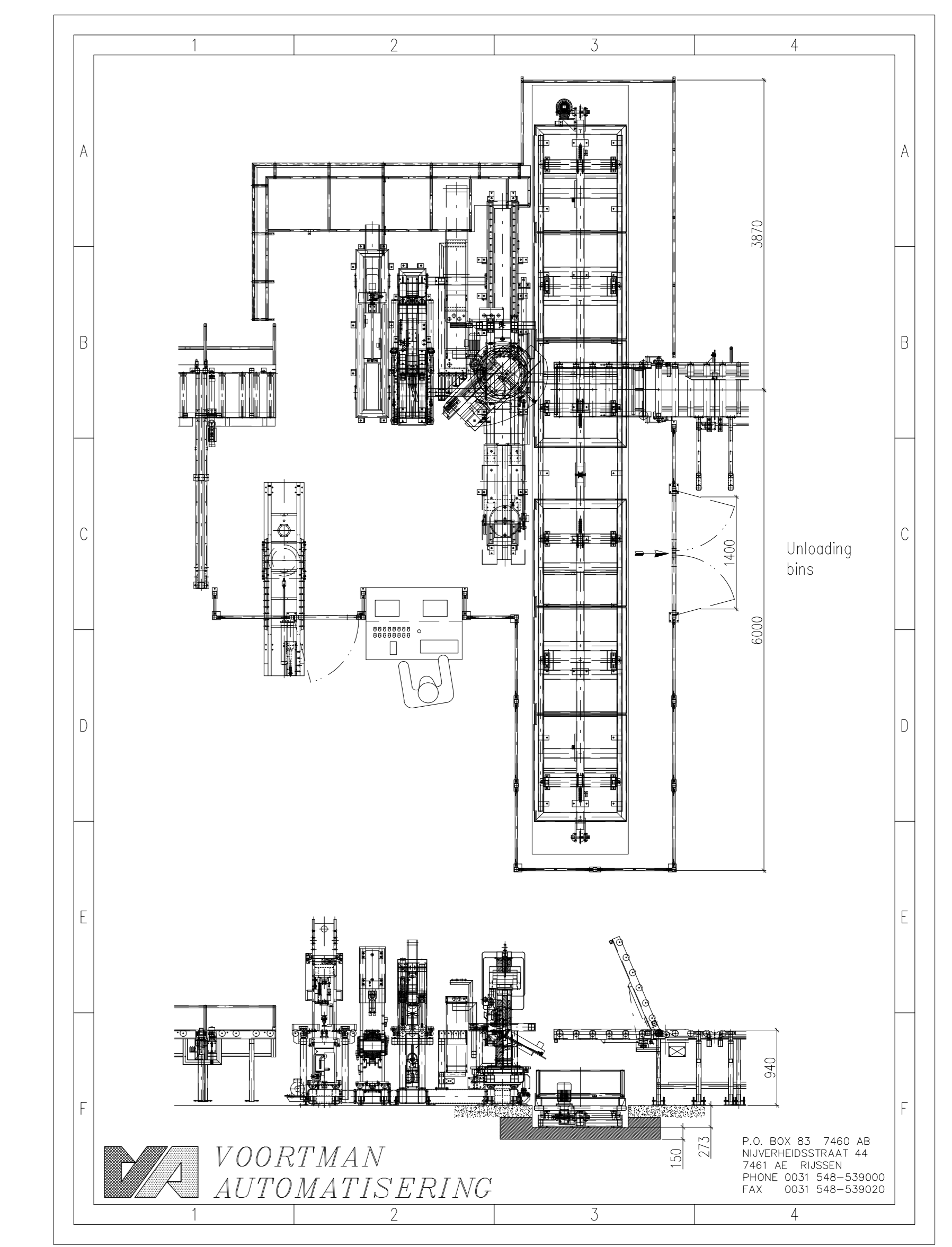

Revision	Description
00	-

**Working height 760mm [30"]**

Total Voortman equipment has to be installed on reinforced concrete, concrete floor quality C20/25 according to NEN-EN 206-1:2001 EN.

The Voortman equipment is designed to operate on a true horizontal plane and the floor. Floor has to be capable of carrying the applied load without settlement, flexing or crushing and have sufficient mass and stiffness to support the equipment.

Anchor bolts will be used to secure the machine to the floor and Voortman is not responsible for any damages with regards to e.g. embedded floor heating.

Contraction joints underneath the machine area are not allowed.

The floor needs to be flat and level for the total Voortman machine area.

Between measuring points at an intermediate distance of 500mm [19"], the maximum allowable difference is 6mm [15/64"].

- Max. permitted deviation for floor flatness and levelness is 50 mm [2"] for total equipment area.
- Max. permitted deviation for floor flatness and levelness is 20 mm [3/4"] for total cutting table area.

**LEGEND**

- EPS Electric powersupply
- CAS Compressed air supply (reducers and dryers to be supplied by customer)
- BIS Broadband internet supply
- EDFU Exhaust ducting to Filterunit (to be supplied by customer)
- GS Gas supply (reducers to be supplied by customer)

Sender Receiver   
 Lightguard to be supplied and installed by Voortman

Fence to be supplied and installed by Voortman Height 2000mm

Description: Concept Quotation Layout	Paper size: A0
Customer: -	Version: 00
Machine type(s): See lay-out	Scale: 1:50
	Drawn by: K106
	Date: 14-11-2023

Ozonstraat 1, NL-7463 PK Rijssen  
 PO Box 87, NL-7460 AB Rijssen  
 (t) +31-0548-53 93 72  
 (f) +31-0548-53 93 74  
 (e) info@voortman.nl  
 (w) www.voortman.nl

Copyright reserved  
 Document Id:  
 -----  
 WTLAS200.dwg